

Model	COM	Ethernet	Monitoring	Alarm	Data Record	Validity	WPN Pass-through	Script
V-BOX E-00	2 in 1	1	200	50	20	60 days /1 millions	N/A	N/A
V-BOX E-4G	2 in 1	1	250	100	50	90 days /1 millions	N/A	YES

## SPECIFICATIONS

Items	V-BOX E-00	V-BOX E-4G
OS		Linux
CPU		RAM 9
Flash		128MB
RAM		DDRIII 64MB
SD Card		N/A
USB		OTG USB / Device USB
Serial Port		COM1: RS232, RS422 / RS485 (2 in 1)
Ethernet Port		1 Ethernet port
WIFI Modules		N/A
4G Modules	N/A	4G
Power Supply		24VDC (12~28VDC)
Power Consumption		<10W
Enclosure		Metal shell
Dimension(W*H*D)		101.0mm*73.2mm*26.8mm
Mounting Size		110.0mm*15.6mm
Weight (KG)		0.26
Vibration Resistance		IEC61131-2 Standard
Storage Temperature		-20°C~70°C
Working Temperature		-10°C~60°C
Relative Humidity		10~85% RH (Non-condensing)
CE Certification		CE marked
FCC Certification		FCC Class A
Http Interface		Yes
Remote Update		Yes
Configuration Backup		Yes
Off-line Transmission		Yes
GPS	N/A	LBS

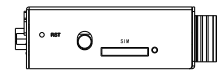
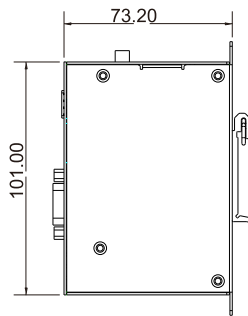
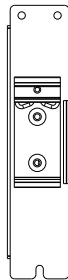
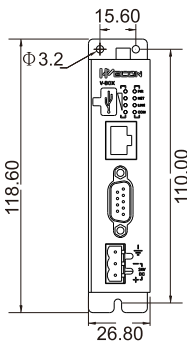

Model	COM	Ethernet	Monitoring	Alarm	Data Record	Validity	WVPN Pass-through	Script
V-BOX H-00	4 in 3	3	300	200	50	90 days / 1 millions	N/A	Yes
V-BOX H-4G	4 in 3	3	500	300	100	180 days / 1 millions	YES	Yes
V-BOX H-AG (Global)	4 in 3	3	600	300	100	180 days / 1 millions	YES	Yes
V-BOX H-WF	4 in 3	3	300	200	50	90 days / 1 millions	YES	Yes
V-BOX H-SG	4 in 3	3	600	300	100	180 days / 1 millions	YES	Yes

## SPECIFICATIONS

Items	V-BOX H-00	V-BOX H-4G / H-SG	V-BOX H-AG	V-BOX H-WF
OS	Linux			
CPU	Cortex A7			
Flash	128MB			
RAM	DDRIII 128MB			
SD Card	N/A			
MICRO USB	USB Host/Device : USB OTG Switch			
Serial Port	COM1 : RS232, RS485/RS422 (2 in 1)			
	COM2 : RS485			
	COM3 : RS485			
Digital I / O	2 inputs with optocoupler isolation; 2 relay outputs			
Ethernet Port	3 Ethernet ports (2*LAN+1*WAN)			
WIFI Module	N/A	N/A	N/A	YES
4G Modules	N/A	4G	4G	N/A
Power Supply	24VDC (12~28VDC)			
Power Consumption	<10w			
Enclosure	PC+ABS			
Dimension (W*H*D)	131.0mm*100.5mm*46.0mm			
Weight (KG)	0.3			
Vibration Resistance	IEC61131-2 Standard			
Storage Temperature	-20°C~70°C			
Working Temperature	-10°C~60°C			
Relative Humidity	10~85% RH (Non-condensing)			
CE Certification	CE Marked			
FCC Certification	FCC Class A			
HTTP Interface	Yes			
Remote Update	Yes			
Configuration Backup	Yes			
Off-line Transmission	Yes			
GPS	N/A	LBS / GPS	LBS	N/A

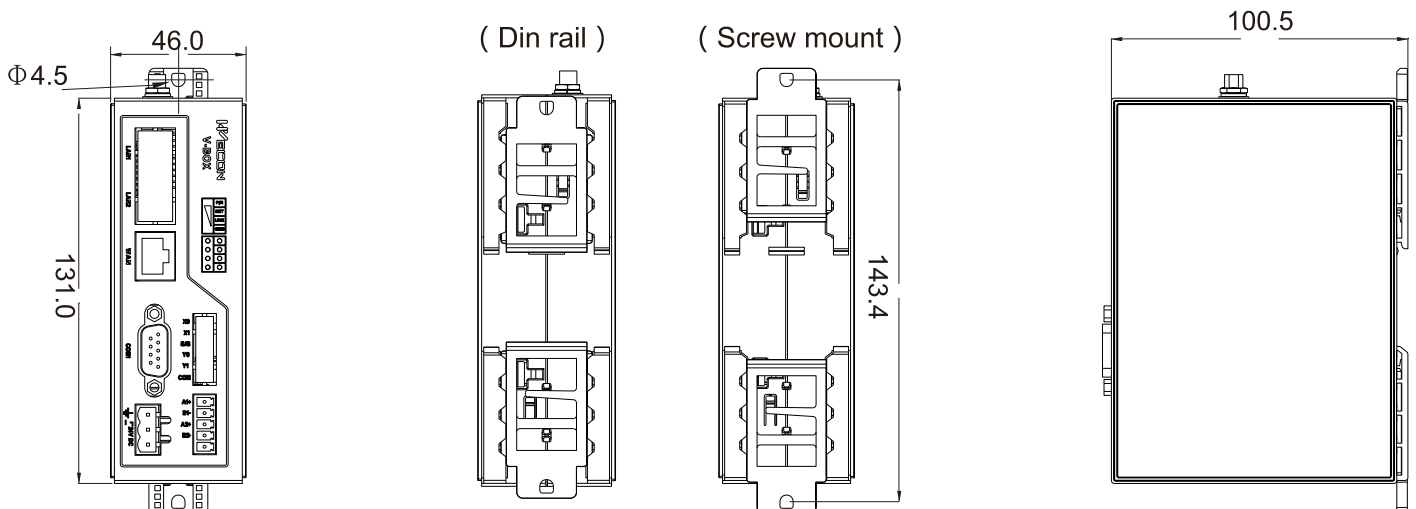

Model	COM	Ethernet	Monitoring	Alarm	Data Record	Validity	WVPN Pass-through	Script
V-BOX RE-00	2 in 1	1	100	20	50	60 days /1 millions	YES	YES
V-BOX RE-4G	2 in 1	1	100	20	50	60 days /1 millions	YES	YES

## SPECIFICATIONS

Items	V-BOX RE-00	V-BOX RE-4G
OS		Linux
CPU		High performance CPU
Flash		128MB
RAM		DDRIII 64MB
SD Card		N/A
USB		OTG USB / Device USB
Serial Port		COM1: RS232, RS422 / RS485 (2 in 1)
Ethernet Port		1 Ethernet port
WIFI Modules		N/A
4G Modules	N/A	4G
Power Supply		24VDC (12~28VDC)
Power Consumption		<10W
Enclosure		Metal shell
Dimension(W*H*D)		101.0mm*73.2mm*26.8mm
Mounting Size		110.0mm*15.6mm
Weight (KG)		0.26
Vibration Resistance		IEC61131-2 Standard
Storage Temperature		-20°C~70°C
Working Temperature		-10°C~60°C
Relative Humidity		10~90% RH (Non-condensing)
CE Certification		CE marked
FCC Certification		FCC Class A
Programming		PIStudio
HTTP Interface		Yes
Remote Update		N/A
Configuration Backup		N/A
Off-line Transmission		Yes
GPS	N/A	LBS
Big Screen Display		Yes
HDMI		N/A

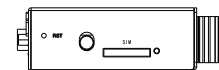
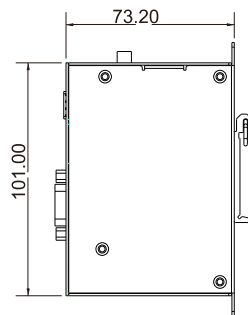
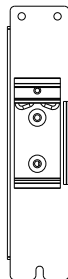
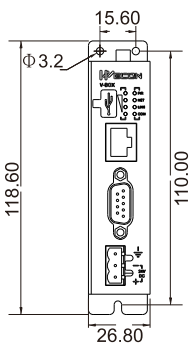

Model	COM	Ethernet	Monitoring	Alarm	Data Record	Validity	WVPN Pass-through	Script
V-BOX RH-WF	4 in 3	2	300	200	100	60 days / 1 millions	YES	Yes

## SPECIFICATIONS

Items	V-BOX RH-WF
OS	Linux
CPU	High Performance CPU
Flash	8GB
RAM	2GB
TF Card	YES
USB HOST	USB 2.0 * 1; USB 3.0*1
USB DEVICE	TYPE-C * 1
Serial Port	COM1 : RS232, RS485/RS422 (2 in 1)
Ethernet Port	COM2: RS485
WIFI Module	2 * Ethernet ports
4G Modules	YES
Power Supply	N/A
Power Consumption	24VDC (12~28VDC)
Enclosure	<10w
Dimension (W*H*D)	PC+ABS
Weight (KG)	125.0mm*93.7mm*51.0mm
Vibration Resistance	0.30
Storage Temperature	IEC61131-2 Standard
Working Temperature	-20°C~70°C
Relative Humidity	-10°C~60°C
CE Certification	10~90% RH (Non-condensing)
FCC Certification	CE Marked
Programming	FCC Class A
HTTP Interface	PIStudio
Remote Update	Yes
Configuration Backup	N/A
Off-line Transmission	Yes
GPS	N/A
Big Screen Display	Yes
HDMI	Yes



Unit : mm , error range: ±0.5mm

